

Multi-Axis Controller V14



The V14 is a robust switching device for remote control and electro-hydraulic applications. Due to its modular design, this control unit can be used universally. The integrated sensor system has signal and potentiometer tracks in conductive plastic technology. Switching contacts are also available as an option.

Technical data

Mechanical life V14	6 million operating cycles
Operation temperature	-40°C to +85°C
Degree of protection	Up to IP65



	V14L	S8	P	T	Example -01 Z C	+03 R	-A05 C61	+A110	-X
Basic unit	V14L Multi-Axis Controller 2-axis left								
Control-handle extended	Standard 60 mm**								
S8	+20 mm								
<i>*Only available in combination with grip!</i>									
Gate	P Cross gate								
Grip / Palm Grip	T Dead man								
Axis 1 (direction 1-2)	01 2 contacts (2A 250 V AC15)								
Z	Spring return								
C	Mechanical encoder								
Axis 2 (direction 3-4)	03 6 contacts (2A 250 V AC15)								
R	Friction brake								
Description axis 1 (direction 1-2)	A05 Arrangement MSP21								
C61	Mechanical encoder MEC 1-2								
Description axis 2 (direction 3-4)	A110 Arrangement MS24-0								
Special model	X Special / customer specified								

Technical details may vary based on configuration or application! Technical data subject to change without notice!

Combination possibilities with our grips



	V14L	S8	P	T	-	01 Z C	+	03 R	-	A05	C61	+	A110	-	X	
Basic unit																
V14.1L	1-axis left															
V14.1R	1-axis right															
V14L	2-axis left															
V14R	2-axis right															
Control-handle extended																
	Standard 60 mm*															
S8	+20 mm															
*Only available in combination with a handle!																
Gate																
P	Cross gate															
P X	Special gate															
Grip / Palm Grip																
	Knob 25 mm (standard)															
M	Mechanical zero interlock															
MH	Mechanical zero interlock + signal contact															
T	Dead man															
H	Signal button															
GK1	Knob 42 mm															
GK1M	Mechanical zero interlock															
GK1MN	Mechanical zero interlock (push down)															
GK1T	Dead man															
GK1H	Signal button															
GK1MH	Mechanical zero interlock + signal contact															
GK1D	Push button															
GK1DV	Flush push button															
GS9	Hall-twist grip with spring return															
GS9-D	Hall-twist grip with spring return and push button on top															
B...	Palm Grip B... (see page Palm Grip page 161)															

Identification of the installation variants with switching directions:

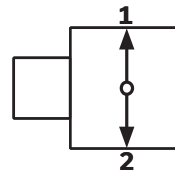

V14.1L

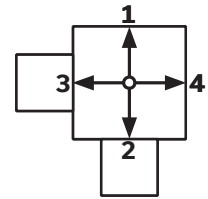

V14L

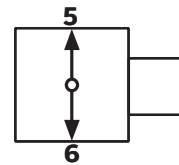

V14.1R

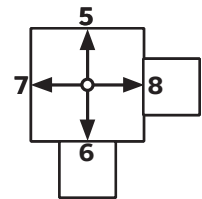

V14R

*Attention! The Multi-Axis Controller V14 is not suitable for large Palm Grips (B3, B7/B8, B9...)

	V14L	S8	P	T	-	01 Z C	+	03 R	-	A05	C61	+	A110	-	X	
Axis 1: direction 1-2 left / direction 5-6 right																
(Standard contacts gold-plated 2A 250V AC15)																
01	2 contacts															
02	4 contacts															
03	6 contacts															
Standard contact - arrangement see page 127																
e.g.																
A05 MS21																
A0500 MS21-00																
A110 MS24-0																
A99 contact - arrangement according customer request																

Technical details may vary based on configuration or application! Technical data subject to change without notice!

	V14L	S8	P	T	-	01 Z C	+	03 R	-	A05	C61	+	A110	-	X
Z	Spring return (included in basic unit!)														
R	Friction brake														
C	Mechanical encoder														
		C61	MEC 1-2												
			EA/02-10				I max. 1 mA								
			Potentiometer track				2 x 10 kOhm								
			Direction tack				Arrangement MS26-0								
		C62	MEC 1-7												
			EA/10-10				I max. 1 mA								
			Potentiometer track				2 x 5 kOhm								
			Direction track				Arrangement MS26-0-1								
H	Hall-Potentiometer		E14811				0,5...2,5...4,5 V / 4,5...2,5...0,5 V								

	V14L	S8	P	T	-	01 Z C	+	03 R	-	A05	C61	+	A110	-	X
Axis 2: direction 3-4 left / direction 7-8 right (Not applied for V14.1L and V14.1R)															
See description axis 1!															
Special model															
X	Special / customer specified														

T = Dead man's button
H = Signal button
M = Latch for mechanical zero interlock

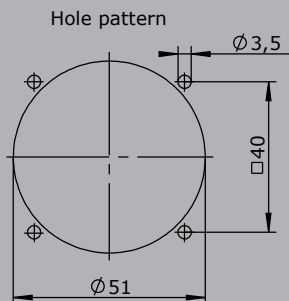
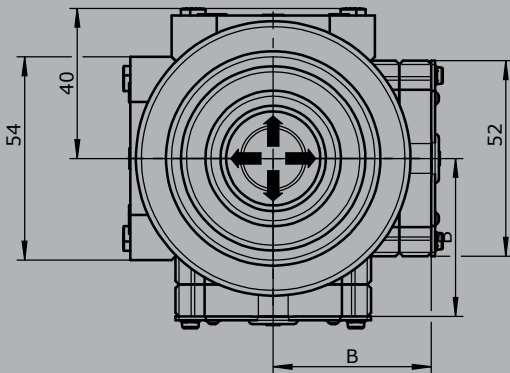
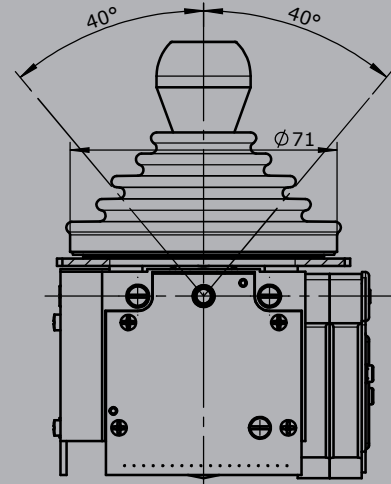
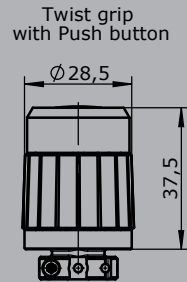
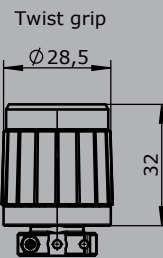
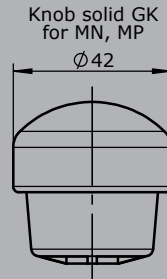
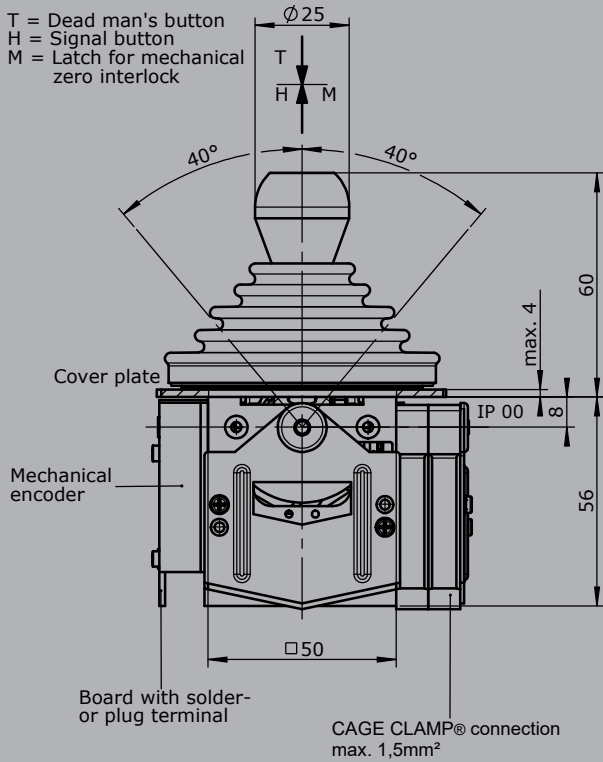

Type	No. of contacts	Dim. B
01	2	36
02	4	45
03	6	54